

GET STARTED

1 Download the app.

Go to whistle.com/start from your iOS or Android device.

2 Set up the Whistle.

Step-by-step instructions for pairing the Whistle and connecting it to your home Wi-Fi network are provided in the app.

3 Charge the Whistle.

Place Whistle on the USB charging dock with button facing away from the cable. Red lights mean Whistle is charging. Green lights mean it is fully charged. Recharging takes about an hour.

Need help? Go to support.whistle.com

ATTACHING / DETACHING

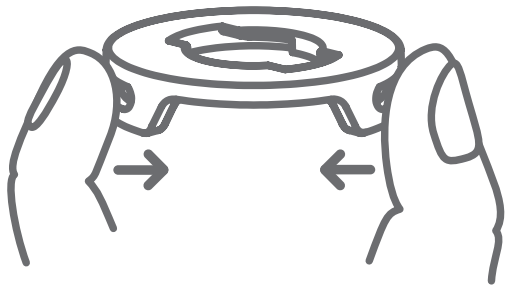

- 1 Squeeze sides of attachment...

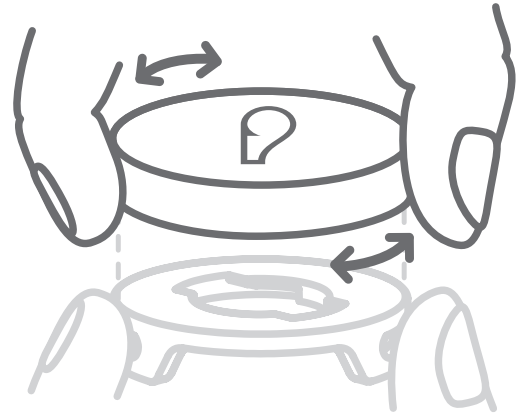

- 2 ...and twist the Whistle.
To attach, turn clockwise until it locks. To detach, turn counterclockwise and lift up.

WHISTLE CARE



The Whistle is waterproof. We recommend rinsing and drying it regularly, especially after swimming, to keep it looking nice.

Need help? Go to support.whistle.com